

Call MEI for Sizes or Capacities Outside Listed Ranges **507.245.3060**

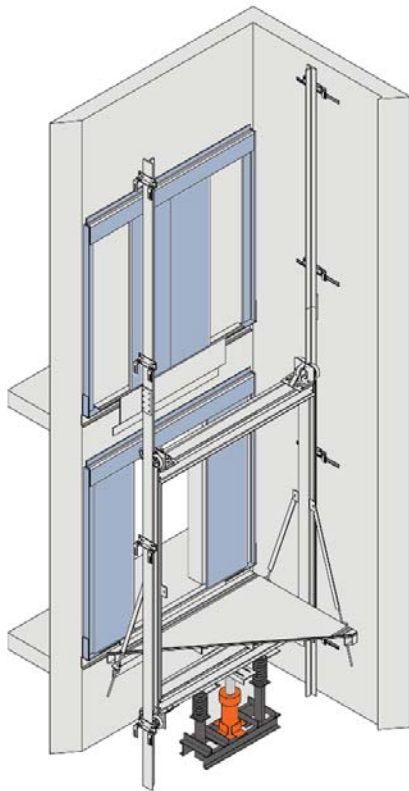

Single Opening (F)

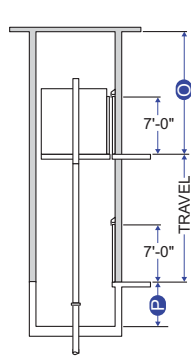

Double Opening (F/R)

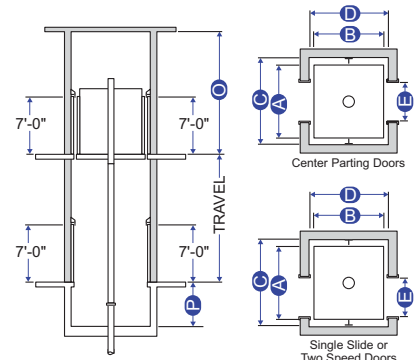

**A** = Platform Width  
**B** = Platform Depth

**C** = Hoistway Width  
**D** = Hoistway Depth

**E** = Clear Door Opening  
**O** = Overhead

**P** = Pit Depth

## Application Summary

This is the traditional design used for decades. It utilizes a single-stage hydraulic jack installed in the ground. The jack is located directly under the car, near the center of the platform.

## Advantages

- Usually the lowest material cost application.
- Accommodates front and rear openings in any configuration.
- No extensive pit or overhead is required.
- Available for both low and high capacity cars.
- Of all the application types, this equipment package is the easiest to install.

## Disadvantages

- Oil contamination in the ground is possible. As a precaution, the jack can be enclosed in PVC pipe. Areas with frequent seismic activity will have the greatest risk of oil contamination.
- The jack must go down into the ground roughly the same distance as the desired travel (*multi-stage jacks can reduce this distance*). Drilling a jack hole is expensive and may be nearly impossible in certain structural or geologic conditions.



Do not use hoistway dimensions for construction purposes. Different code year adoptions and local code variations may affect the hoistway size. Verify all dimensions with MEI prior to construction.

|               | Capacity (lbs)      | Platform<br><b>A</b> x <b>B</b> | Hoistway<br><b>C</b> x <b>D</b> | Front/ Rear     | Laminate Clear Inside<br>W x D | Door Type | Door Width<br><b>E</b> |
|---------------|---------------------|---------------------------------|---------------------------------|-----------------|--------------------------------|-----------|------------------------|
| Low Capacity  | 2100                | 6'-0" x 5'-1"                   | 7'-4" x 5'-9"                   | F               | 5'-9" x 4'-3 1/2"              | 1-SP      | 3'-0"                  |
|               | 2100                | 6'-0" x 5'-8"                   | 7'-4" x 6'-8 1/2"               | F/R             | 5'-9" x 4'-3 1/2"              | 1-SP      | 3'-0"                  |
|               | 2500                | 7'-0" x 5'-1"                   | 8'-4" x 5'-9"                   | F               | 6'-9" x 4'-3 1/2"              | 1-SP      | 3'-6"                  |
|               | 2500                | 7'-0" x 5'-8"                   | 8'-4" x 6'-8 1/2"               | F/R             | 6'-9" x 4'-3 1/2"              | 1-SP      | 3'-6"                  |
|               | 3000                | 7'-0" x 5'-6"                   | 8'-4" x 6'-2"                   | F               | 6'-9" x 4'-8 1/2"              | 1-SP      | 3'-6"                  |
|               | 3000                | 7'-0" x 6'-1"                   | 8'-4" x 7'-1 1/2"               | F/R             | 6'-9" x 4'-8 1/2"              | 1-SP      | 3'-6"                  |
|               | 3500                | 7'-0" x 6'-2"                   | 8'-4" x 6'-10"                  | F               | 6'-9" x 5'-4 1/2"              | 1-SP      | 3'-6"                  |
|               | 3500                | 7'-0" x 6'-9"                   | 8'-4" x 7'-9 1/2"               | F/R             | 6'-9" x 5'-4 1/2"              | 1-SP      | 3'-6"                  |
|               | 4000                | 8'-0" x 6'-2"                   | 9'-4" x 7'-0"                   | F               | 7'-9" x 5'-3"                  | 2-SP      | 4'-0"                  |
|               | 4000                | 8'-0" x 6'-8"                   | 9'-4" x 7'-11 1/2"              | F/R             | 7'-9" x 5'-0 1/2"              | 2-SP      | 4'-0"                  |
| Hospital      | 3500H               | 5'-4" x 8'-4"                   | 6'-8" x 9'-2"                   | F               | 5'-1" x 7'-5"                  | 2-SP      | 3'-6"                  |
|               | 3500H               | 5'-4" x 9'-0 1/2"               | 6'-8" x 10'-4"                  | F/R             | 5'-1" x 7'-5"                  | 2-SP      | 3'-6"                  |
|               | 4000H               | 6'-0" x 8'-5"                   | 7'-4" x 9'-3"                   | F               | 5'-9" x 7'-6"                  | 2-SP      | 4'-0"                  |
|               | 4000H               | 6'-0" x 9'-1 1/2"               | 7'-4" x 10'-5"                  | F/R             | 5'-9" x 7'-6"                  | 2-SP      | 4'-0"                  |
|               | 4500H               | 6'-0" x 9'-2"                   | 7'-4" x 10'-0"                  | F               | 5'-9" x 8'-3"                  | 2-SP      | 4'-0"                  |
|               | 4500H               | 6'-0" x 9'-10 1/2"              | 7'-4" x 11'-2"                  | F/R             | 5'-9" x 8'-3"                  | 2-SP      | 4'-0"                  |
|               | 5000H               | 6'-0" x 9'-7 1/2"               | 7'-6" x 10'-5 1/2"              | F               | 5'-9" x 8'-8"                  | 2-SP      | 4'-0"                  |
|               | 5000H               | 6'-0" x 10'-3 1/2"              | 7'-6" x 11'-7"                  | F/R             | 5'-9" x 8'-8"                  | 2-SP      | 4'-0"                  |
| High Capacity | 6000                | 7'-0" x 8'-6"                   | 8'-6" x 9'-4"                   | F               | 6'-9" x 7'-7"                  | 2-SP      | 4'-0"                  |
|               | 6000                | 7'-0" x 9'-2 1/2"               | 8'-6" x 10'-6"                  | F/R             | 6'-9" x 7'-7"                  | 2-SP      | 4'-0"                  |
|               | 8000                | 8'-4" x 10'-0"                  | 9'-10" x 10'-10"                | F               | 8'-1" x 9'-1"                  | 2-SP      | 4'-0"                  |
|               | 8000                | 8'-4" x 10'-8 1/2"              | 9'-10" x 12'-0"                 | F/R             | 8'-1" x 9'-1"                  | 2-SP      | 4'-0"                  |
|               | 10000               | 8'-4" x 11'-8 1/2"              | 9'-10" x 12'-6 1/2"             | F               | 8'-1" x 10'-9 1/2"             | 2-SP      | 4'-0"                  |
|               | 10000               | 8'-4" x 12'-5"                  | 9'-10" x 13'-8 1/2"             | F/R             | 8'-1" x 10'-9 1/2"             | 2-SP      | 4'-0"                  |
|               | 12000               | 10'-4" x 11'-6"                 | 11'-10" x 12'-4"                | F               | 10'-1" x 10'-7"                | 2-SP      | 4'-0"                  |
|               | 12000               | 10'-4" x 12'-2 1/2"             | 11'-10" x 13'-6"                | F/R             | 10'-1" x 10'-7"                | 2-SP      | 4'-0"                  |
| 15000         | 12'-0" x 11'-5"     | 13'-6" x 12'-3"                 | F                               | 11'-9" x 10'-6" | 2-SP                           | 4'-0"     |                        |
| 15000         | 12'-0" x 12'-1 1/2" | 13'-6" x 13'-5"                 | F/R                             | 11'-9" x 10'-6" | 2-SP                           | 4'-0"     |                        |

**P** Pit Depth = 4'-0" • **O** Minimum Overhead = 12'-0" • Cab Height = 8'-0"